



Operating Guide
Manuel d'utilisation
Gebruiksaanwijzing
Manual de funcionamiento
Guida all'uso
Gebrauchsanweisung

Drinkwell® Big-Dog Pet Fountain - 8.5 Litres

Fontaine pour animaux de compagnie - 8,5 Litres

Fontein voor huisdieren - 8,5 Liter

Fuente para Mascotas - 8,5 Litros

Fontana per animali domestici - 8,5 Litri

Haustierbrunnen - 8,5 Liter



Please read this entire guide before beginning

Veuillez lire ce manuel en entier avant de commencer

Gelieve deze gids volledig door te lezen voordat u begint

Por favor, lea este manual completamente antes de empezar

Si prega di leggere attentamente la guida al uso prima di utilizzare il collare

Bitte lesen Sie die gesamte Betriebsanleitung vor dem Trainingsbeginn

400-1350-19

www.petsafe.net

1



DRINKWELL®

U.S. Patents No. 5799609, 5842437, and 6055934

WARRANTY

To get the most protection out of your warranty, please register your product within 30 days at www.petsafe.net. By registering, and keeping your receipt, you will enjoy the product's full warranty and should you ever need to call the Customer Care Centre we will be able to help you faster. Most importantly, PetSafe® will never give or sell your valuable information to anyone. Complete warranty information is available online at www.petsafe.net.

For a full listing of our Customer Care Centre telephone numbers, visit our website at www.petsafe.net.

Table of Contents

Important Safety Instructions.....	3
Components.....	4
Features.....	4
Operating Instructions.....	5
Fountain Cleaning Instructions.....	7
Reassembling the Fountain.....	9
Fountain and Your Environment.....	10
Tips on Use.....	11
CE Compliance & Recycling Information.....	11
Manufacturer's Safety Instructions.....	12
Français	13
Nederlands	24
Español	35
Italiano	46
Deutsch	57



DRINKWELL®

U.S. Patents No. 5799609, 5842437, and 6055934

IMPORTANT SAFETY INSTRUCTIONS

Instructions pertaining to: Risk of Fire, Electrical Shock, or Harm to Persons.

- 1) Read all the instructions before using the appliance.
- 2) To reduce the risk of injury, close supervision is necessary when an appliance is used near children.
- 3) Only use attachments recommended or sold by the manufacturer.
- 4) Do not use outdoors. **FOR INDOOR USE ONLY.**
- 5) Do not unplug by pulling on cord. To unplug, grasp the plug, not the cord.
- 6) Do not operate any appliance with a damaged cord or plug, or after the appliance malfunctions or is dropped or damaged in any manner. Immediately call your country's Customer Care Centre for further instructions.
- 7) For a portable appliance - To reduce the risk of electrical shock, do not place or store appliance where it can fall or be pulled into a tub or sink.
- 8) Always unplug any appliance when not in use, before putting on or taking off parts, and before cleaning. Never pull on the cord to remove the adaptor from the wall outlet.

SAVE THESE INSTRUCTIONS



DRINKWELL®

U.S. Patents No. 5799609, 5842437, and 6055934

Components

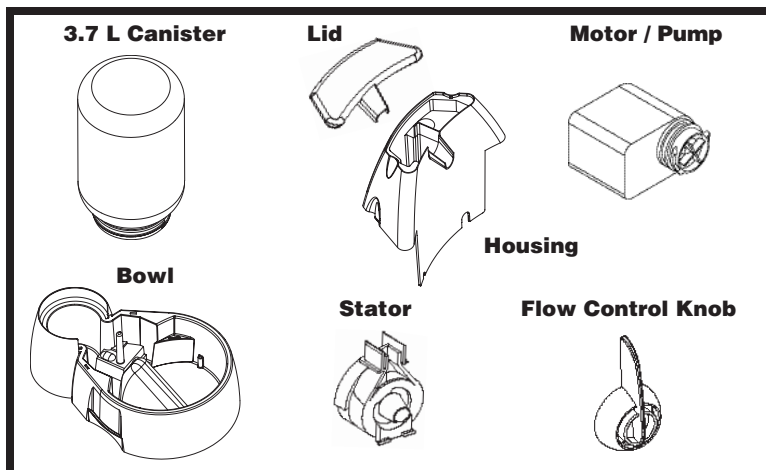

Features

Attached Reservoir (3.7 L) allows for easy refills and increases capacity

Patented free-falling water stream encourages pets to drink more water

Anti-Bite Cord Cover

Replaceable Charcoal Filter removes bad tastes and odors

Receiving ramp reduces splash of falling water

Adjustable Flow Control

8.5 L Water Capacity



OPERATING INSTRUCTIONS

DO NOT RUN DRY - FOR INDOOR USE ONLY

- 1) As with any electrical device, check the electrical cord for any tears or damage before use.
- 2) Inspect the bottom of the fountain to be sure the motor is securely attached. (See Fig. 1)
- 3) Remove the housing lid and insert the charcoal filter. The filter will fit diagonally into the housing. The filter fits narrow side down, with the black side facing the front of the fountain (toward the spout). The filter will slide easily into place, but make sure it is pushed all the way down. (See Fig. 2)

Fig. 1

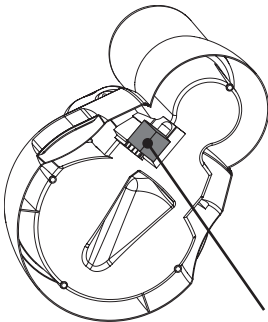

MOTOR

Fig. 2

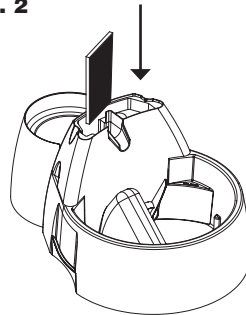

NOTE: Rinse the filter thoroughly under cool water before placing in the fountain. This will remove any loose charcoal dust, which is harmless. A small amount of charcoal dust may shed for the life of the filter. This is normal and not harmful to your pet.

- 4) Place fountain in desired location before adding the reservoir. If placing on carpet, tile or wood flooring use a protective mat or other durable, water resistant surface to protect your floors from splashing or dripping caused by the pet.
- 5) Fill both the bowl and the fountain housing with water only until the water reaches the fill level in the bowl.

OPERATING INSTRUCTIONS

- 6) Before you plug the fountain in, make sure the cord and your hands are dry. Plug the fountain into an electrical outlet.
- 7) Fill reservoir with water.
- 8) Check the lid to make sure the black O-ring is in place, then screw the lid onto the reservoir.
- 9) Hold the container over the reservoir base of the fountain. Quickly turn the reservoir upside down and place the lid's spout into the reservoir base. (See Fig. 3)

Fig. 3

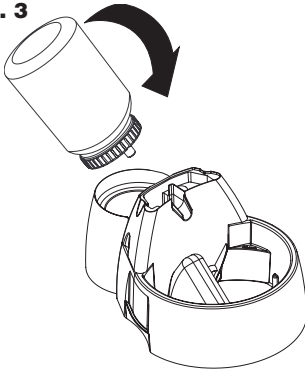
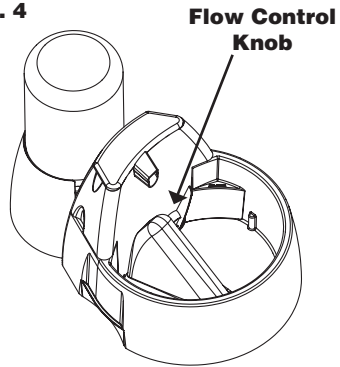

Fig. 4



- 10) Set your desired flow rate with the flow control knob, which is next to the ramp inside the bowl. When the knob is in the 10 o'clock position, flow is at its lowest. When the knob is in the 2 o'clock position, flow is at its highest. (See Fig. 4)
- 11) Add water to the bowl as needed. Do not let the water level fall below the flow control knob or you may burn out the motor. Never pick up a full fountain by the filter housing. Only pick up the fountain by placing both hands underneath the base of the fountain and grip the sidewalls for a sturdy hold.

FOUNTAIN CLEANING

Filters: Change every 2 to 4 weeks

- 1) Filters should be changed every two to four weeks. Replace the filters more frequently when using the fountain for multiple pets or pets that produce a lot of saliva.
- 2) Filters are an added feature of the fountain. Their use is not required for normal operation, but will keep the fountain water cleaner.
- 3) Filters may be rinsed out when the fountain is cleaned. Never wash the filter with soapy water, you will not be able to remove the soap residue.

Fountain: Clean once a week

- 1) Lift the reservoir out of the back of the fountain and quickly turn upright.
- 2) Unscrew the reservoir lid and remove the O-ring.
- 3) Next, unplug fountain, remove the housing lid, and remove the filter.
- 4) Empty the water out of the fountain.
- 5) Remove the filter housing by pressing in the tabs at the sides and lifting up. (See Fig. 5)
- 6) The flow control knob and stator are not attached and are freed when the housing is removed.

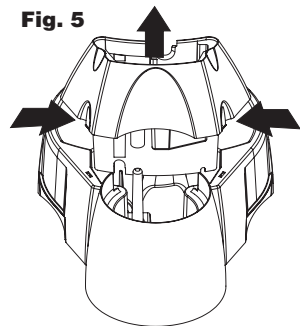

IMPORTANT: Motor must be cleaned regularly or the warranty may be voided. See next page for detailed instructions.

7) Motor Removal & Cleaning

- a) Turn the bowl over and unlock the motor from its cavity by slipping your finger into the indentation behind the motor and pulling that end of the motor out toward you, so that it has turned a quarter of a turn (See Fig. 6). Do not attempt to remove motor without turning it 90 degrees, this may damage the fountain and cause a leak.
- b) Now that the motor is unlocked, remove it from the fountain. If you find this difficult, you can push the motor out from the bowl side.
- c) Carefully lift the impeller (the white “propeller”) out of the motor. It should slide out with no resistance. Remove any hair tangled around it and wash it with the rest of the parts.
- d) Pour soapy water inside the motor cavity and clean it with a small round bristle brush (Cleaning Kits are available). Rinse well and replace the impeller after it is cleaned.

Fig. 6

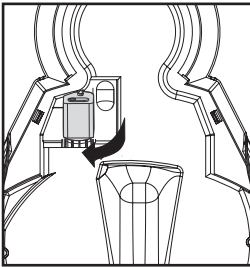
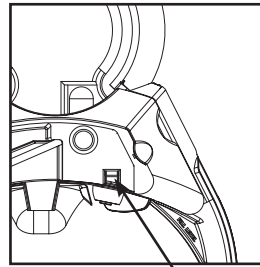

Fig. 7



**Square Intake
Tube**

- 8) Hand wash the rest of the fountain parts in soapy water and rinse well. You may place items in the dishwasher, but if your dishwasher is too hot - the plastic parts can be damaged. Use a longer bristle brush to clean the square intake tube in the filter housing. (See Fig. 7) The reservoir is not dishwasher safe.

FOUNTAIN REASSEMBLY

- 1) Turn the bowl upside down. Reattach the motor by pushing the threads of the motor through the hole in the bowl. The motor goes in at a right angle to the bowl (Fig. 8a). If you cannot turn the motor into its resting position (Fig. 8b), the motor is not pushed into the hole as far as it will go.

Fig. 8a

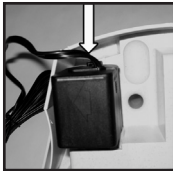
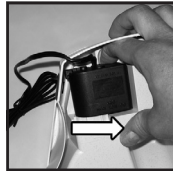
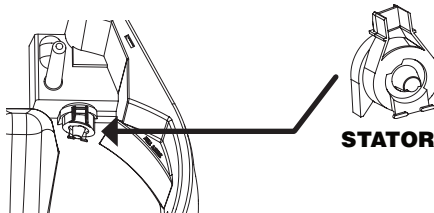

Fig. 8b



- 2) After turning the motor a quarter turn, it should now be even with the bottom of the bowl (Fig. 8b). Turn the bowl back over.
- 3) Place the stator over the exposed portion of the motor found in the bowl. (See Fig. 9)

Fig. 9



- 4) Join the flow control knob and stator together by placing the tabs of the knob into the groove of the stator. (See Fig. 10)

Fig. 10

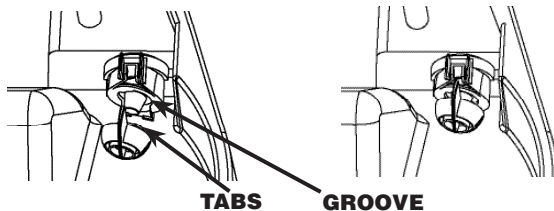

- 5) Hold these parts in place with one hand while attaching the housing with the other hand. (See Fig. 11 - Next Page) Attach the housing by sliding the cutout in the wall of the housing down in between the control knob and stator. The housing will click into place, when the side tabs are inserted in the bowl. (See Fig. 12 - Next Page)

Fig. 11

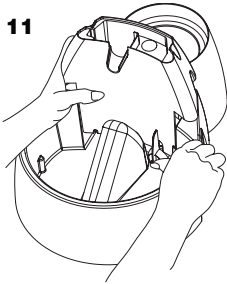
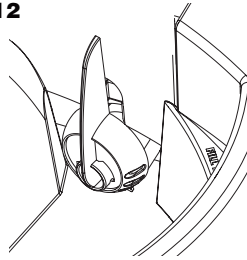

Fig. 12



- 6) Place the fountain in desired location. Make sure to use a protective surface, such as a towel or place mat, to protect your floors from splashing or dripping from your pet.
- 7) Replace the filter and fill the housing, bowl, and reservoir with water. Replace the lid.
- 8) Before you plug the fountain in, make sure your hands and the cord are dry. Check the cord for any damage before plugging in the fountain. Plug the fountain into an electrical outlet.

THE FOUNTAIN AND YOUR ENVIRONMENT

If you live in a humid environment and have problems with mold or algae, soak all the parts in a diluted bleach solution for about 10 minutes after regular cleaning. Use a 10% bleach and 90% water solution. Pour some of the bleach solution down into the motor cavity too. This is an excellent way to disinfect the fountain. However, you must be sure to rinse all the parts thoroughly in water to remove all the chlorine.

If you have hard water, you may start to see white mineral deposits on or inside the motor. This can eventually prevent the impeller from turning properly. To avoid having to replace the motor, please take the following steps:

- 1) Clean the motor more frequently than you have in the past; or
- 2) Clean the motor with a vinegar solution (20% White Vinegar and 80% Water) and let the solution soak for several minutes down inside the motor cavity; or
- 3) Use bottled water instead of faucet water.

TIPS ON USE

When being introduced to the Drinkwell® Big Dog Pet Fountain, your pet may be cautious of this new and unusual object. After beginning operation of your fountain, simply allow your pet to adjust at his or her own pace. Some pets may take several days or longer to begin use, while others will start right away.

Your pet may prefer that the fountain be placed away from their normal feeding area. Try placing it in another location, such as a different area of the kitchen or in a bathroom or utility room.

Add ice cubes to the bowl for refreshing, ice-cold running water!

CE COMPLIANCE & RECYCLING



This equipment complies with the EMC and Low Voltage Directives. Unauthorized changes or modifications to the product that are not approved by Radio Systems® Corporation may violate EU regulations, could void the user's authority to operate the equipment, and will void the warranty.

The Declaration of Conformity can be found at:
http://www.petsafe.net/customercare/eu_docs.php



Important Recycling Advice

Please respect the Waste Electrical and Electronic Equipment regulations in your country. This equipment must be recycled. If you no longer require this equipment, do not place it in the normal municipal waste system. Please return it to where it was purchased in order that it can be placed in our recycling system. If this is not possible, please contact the Customer Care Centre for further information.

MANUFACTURER'S SAFETY INSTRUCTIONS

- 1) It is not recommended that any appliance be left running unattended for a prolonged period of time as the water may get consumed or evaporate and cause the motor to run dry.
- 2) Do not allow pets or children to chew on or swallow any parts. If you are concerned about the power cord, purchase a cord conduit (a hard plastic protector) at any hardware store.

3) Standard Safety Precautions

Do not attempt repairs on the motor yourself. Return it under the cover of the warranty.

If the plug of this device gets wet, turn off the electricity to that outlet. Do not attempt to unplug.

To avoid the possibility of the plug or outlet getting wet, the outlet should always be above the level of the fountain.

Examine this appliance after installation. It should not be plugged in if there is water on the cord or plug.

Do not operate any appliance if it has a damaged cord or plug, or if it is malfunctioning or has been damaged.

If an extension cord is necessary, a cord with a proper rating should be used.

FOR INDOOR USE ONLY

- 4) Some animals have been known to be sensitive to plastic food and water containers. If your animal shows signs of an allergic reaction to the plastic, please discontinue use until you have consulted with your veterinarian.

The electrical use of this appliance is 6 watts.

Close supervision is necessary when any appliance is used by or near children.

Always unplug any appliance when not in use, before putting on or taking off parts, and before cleaning. Never pull on an electrical cord to remove from the outlet.

Do not use appliance for anything other than intended use. The use of attachments not recommended or sold by the manufacturer may cause an unsafe condition. Do not modify the unit.

Do not install or store appliance where it will be exposed to weather or temperatures below freezing.

Read and observe all important notices on the appliance and in the packaging.